

**GENERAL NOTES**

1. New windows: Pella, Impervia 250 (typ)
2. Interior door style - 4 shaker panels (typ)
3. Insulate walls and floor from below in the 1st floor Office.
4. Remove paneling in the Office. Put plaster on walls.
5. Remove outside stairs and concrete walkway on the Pantry side.

**DRAWING KEYS**

- existing walls
- demolished walls
- new walls
- possible furniture

Exist bsm floor to 1st floor = 95.5"  
New addition floor to floor = 101.5"  
VIF with homeowner

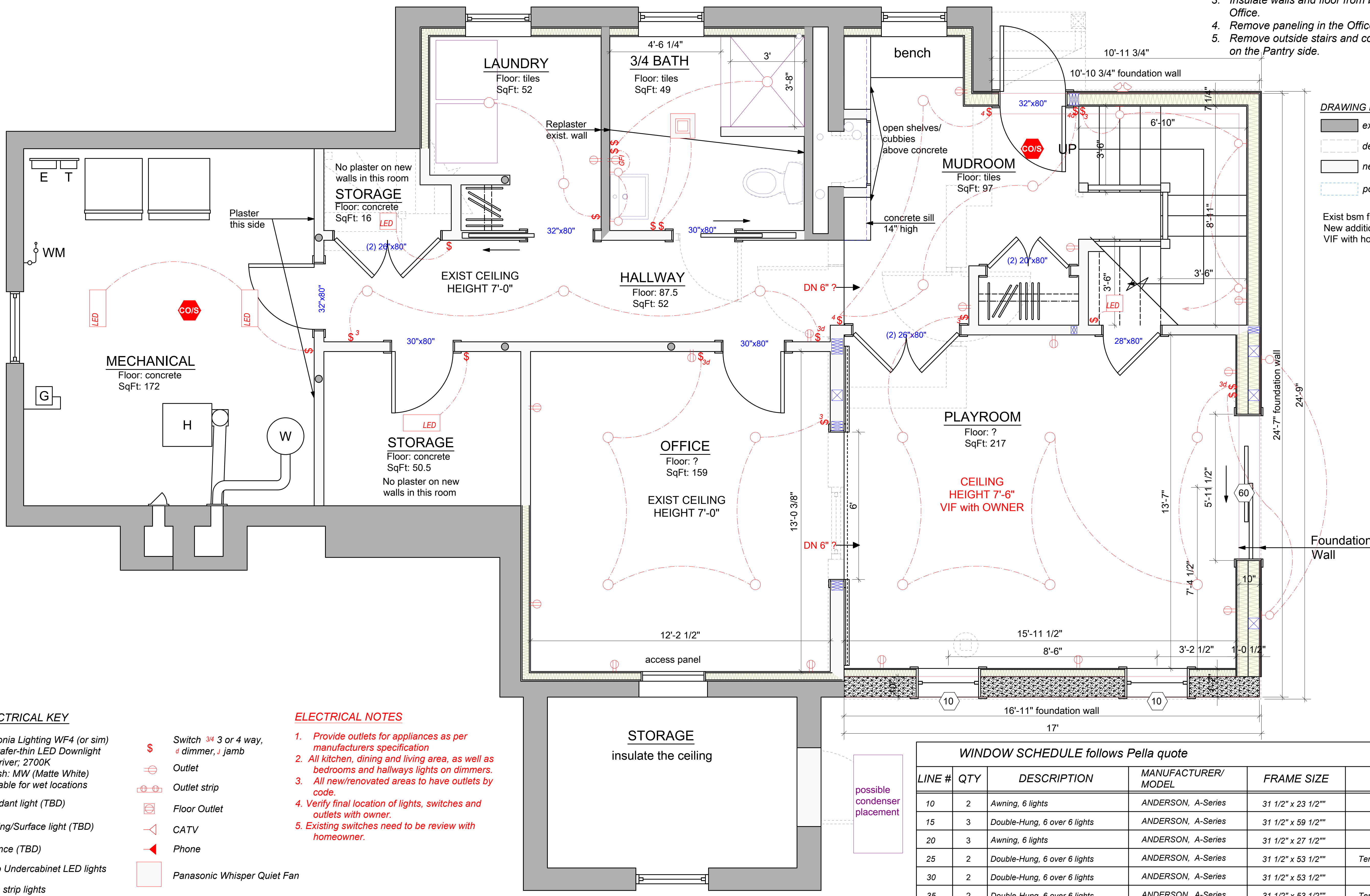

**ELECTRICAL KEY**

- Lithonia Lighting WF4 (or sim) 4" wafer-thin LED Downlight w/ driver; 2700K Finish: MW (Matte White) Suitable for wet locations
- Pendant light (TBD)
- Ceiling/Surface light (TBD)
- Sconce (TBD)
- Strip Undercabinet LED lights
- LED strip lights
- Surface light; LED / Fluorescent
- Double-headed outdoor light Motion Activated (TBD)
- Switch 3/4 3 or 4 way, dimmer, jamb
- Outlet
- Outlet strip
- Floor Outlet
- CATV
- Phone
- Panasonic Whisper Quiet Fan
- Panasonic Whisper Quiet Fan w/Light
- Smoke/CO detector interconnected w/battery backup

**ELECTRICAL NOTES**

1. Provide outlets for appliances as per manufacturers specification
2. All kitchen, dining and living area, as well as bedrooms and hallways lights on dimmers.
3. All new/renovated areas to have outlets by code.
4. Verify final location of lights, switches and outlets with owner.
5. Existing switches need to be review with homeowner.

**1 Proposed Basement Plan**  
Scale: 1/2" = 1'-0"

**WINDOW SCHEDULE follows Pella quote**

LINE #	QTY	DESCRIPTION	MANUFACTURER/ MODEL	FRAME SIZE	REMARKS
10	2	Awning, 6 lights	ANDERSON, A-Series	31 1/2" x 23 1/2"	
15	3	Double-Hung, 6 over 6 lights	ANDERSON, A-Series	31 1/2" x 59 1/2"	
20	3	Awning, 6 lights	ANDERSON, A-Series	31 1/2" x 27 1/2"	
25	2	Double-Hung, 6 over 6 lights	ANDERSON, A-Series	31 1/2" x 53 1/2"	Tempered
30	2	Double-Hung, 6 over 6 lights	ANDERSON, A-Series	31 1/2" x 53 1/2"	
35	2	Double-Hung, 6 over 6 lights	ANDERSON, A-Series	31 1/2" x 53 1/2"	Tempered
40	2	Double-Hung, 6 over 6 lights	ANDERSON, A-Series	27 1/2" x 41 1/2"	Tempered
45	1	Double Sliding Door, Vent Right/Fixed	ANDERSON, A-Series	95 1/2" x 81 1/2"	Tempered
50	1	Casement Right, 12 lights	ANDERSON, A-Series	30 1/2" x 48 1/2"	Egress
55	1	Casement Left, 12 lights	ANDERSON, A-Series	30 1/2" x 48 1/2"	Egress
60	1	Double Sliding Door, Vent Right/Fixed	ANDERSON, A-Series	71 1/2" x 81 1/2"	Tempered
65	1	Double-Hung, 6 over 6 lights	ANDERSON, A-Series	27 1/2" x 41 1/2"	
70	1	Double-Hung, 6 over 6 lights	ANDERSON, A-Series	31 1/2" x 53 1/2"	Tempered
75	1	Double-Hung, 4 over 4 lights	ANDERSON, A-Series	23 1/2" x 41 1/2"	

Designer:  
**Marta Kruszelnicka**

Builder:  
**Don Foote Contracting**  
781-438-2995  
www.donfoote.com

Project:  
**Bellalta Residence**  
11 Mystic Ave  
Winchester, MA

Drawing Title:  
**Proposed Basement Plan**

Dates:  
x/xx/2021 Mtg/Measuring  
x/xx/2021 Exist. Cond.  
x/xx/2021 SchematicDesign  
6/16/2021 SchemDes. Cont.  
8/3/2021 Walkthrough  
8/31/2021 Updates  
9/7/2021 Updates  
8/28/2022 DRC Revisions

Last worked on:  
9/7/2021

Scale:

Drawing #:  
**A1-B**